

Fusíveis Classe J de 1 - 600A, 600VCA
 UL / CSA - Class Cap. de rupt. 200KA
Class J Fuses 600 A / 600 VAC
 UL / CSA - Class Interrupting rating 200KA



- alta cap. de ruptura / high breaking capacity
- baixa perda / low power dissipation
- limitador de corrente / high current limiting

- terminais prateado / silver plated contacts
- baixa voltagem de arco / low switching voltage
- elemento de prata / silver element

Fig. 2

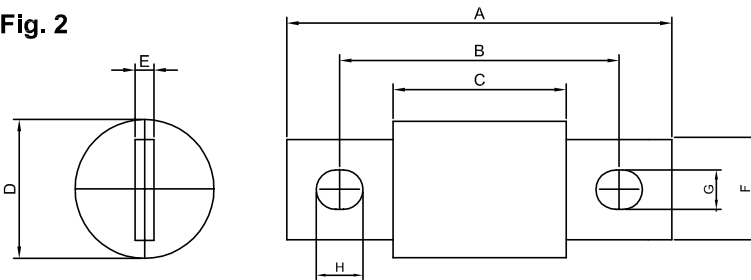
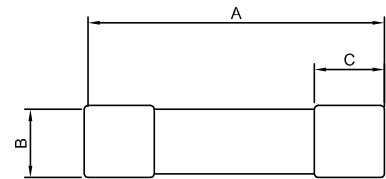

Fig. 1



Dimensões / Dimensions (mm in parentheses)

AMP.	FIG.	A	B	C	D	E	F	G	H
1 - 30	1	1 9/32" (57.1)	19/32" (15.1)	19/32" (15.1)	----	----	----	----	----
35 - 60	1	2-3/8" (60.3)	21/32" (16.6)	21/32" (16.6)	----	----	----	----	----
70 - 100	2	4-5/8" (117.5)	3-5/8" (92.1)	2-5/8" (66.7)	1" (25.4)	1/8" (3.2)	3/4" (19.1)	9/32" (7.1)	3/16" (4.8)
110 - 200	2	5-3/4" (146.1)	5-3/4" (111.1)	3" (76.2)	1-1/2" (38.1)	3/16" (4.8)	1-1/8" (28.6)	9/32" (7.1)	3/16" (4.8)
225 - 400	2	7-1/8" (181.0)	7-1/8" (133.3)	3-3/8" (85.7)	2" (50.8)	1/4" (6.4)	1-5/8" (41.3)	13/32" (10.3)	1/4" (6.3)
450 - 600	2	8" (203.2)	6" (152.4)	3-3/4" (95.3)	2-1/2" (63.5)	3/8" (9.5)	2" (50.8)	17/32" (13.5)	5/16" (7.9)

Tempo Corrente / Time - Current Curve

